



ONE STOP SHOP
One Government Center, Suite 1600, Toledo, OH 43604
419-245-1220 Fax-245-1329

Swimming Pools Requirements

In General

A permit is required for in-ground and a registration is required for above-ground pools.

Site drawings are required with application showing: street address, site location, dimensions from lot lines and other structures, and the scale of drawing.

Pools may not be located beneath overhead electrical service wiring.

Pools are generally located in a rear yard but are allowed in a side yard if setback requirements can be met and the pool does not project to within 3' of the required front yard setback line.

Electrical permit is required by owner/occupant or electrical contractor for wiring - Minimum \$40 plus 1% residential state surcharge or 3% commercial state surcharge.

Pool construction can be done by the owner of the property or a licensed home improvement and remodeling contractor. Contact this office for information on license.

Where a wall of a dwelling serves as part of a barrier, one of the following must be met: 1) Pool equipped with powered safety cover, or 2) Doors with direct access to pool shall have an automatic alarm system, or 3) Doors with direct access to pool must be self-closing with self-latching devices.

Portable Above Ground Pools

- A minimum of 3 feet from property lines.
- Surrounded by a minimum 4' high (barrier) fence unless the side is at least 4 feet high and ladders are removed or locked up when not in use.
- Pool decks, if no higher than 3 feet, shall be at least two feet from adjacent side lot. If higher than 3 feet, the required side yard of 3 feet must be maintained.
- A separate permit is required for construction of a deck with the minimum fee of \$35.00. Detailed construction drawings are required along with the site drawings. Registration fee of \$20 for the above-ground pool.
- An electrical permit may be required if installing any new wiring at a minimum fee of \$40.

Residential In-ground Pools

- Health Department approval required (419 213-4100)
- Must be a minimum of 8 feet from property lines.
- Must be surrounded by a minimum 4' high (barrier) fence.
- Permit fee is \$35 base fee plus \$.05 per gross sq ft.
- Separate pool bonding permits required - \$50 fee.



RESIDENTIAL 1, 2 OR 3 FAMILY ELECTRICAL PERMIT

CITY OF TOLEDO-BUILDING INSPECTION
P.O. Box 844, Toledo, OH 43697
One Gov't Center, Suite 1600, Toledo, OH 43604
419-245-1220 Fax 419-245-1329 www.ci.toledo.oh.us

CONTRACTOR # _____ DATE _____

JOB ADDRESS _____ LOCATION OF WORK _____

OWNER _____ PHONE # ____ - ____ - ____

ADDRESS _____ CITY _____ STATE _____ ZIP CODE _____

CONTRACTOR _____ PHONE # ____ - ____ - ____

ADDRESS _____ CITY _____ STATE _____ ZIP CODE _____

DWELLING UNITS _____ CLASS OF WORK ___NEW CONST. ___ ALTERATIONS ___ ADDITION

WORK DESCRIPTION:	QTY	TOTAL
Temporary Pole _____	\$40.00 Each	_____
Swimming Pool Bonding _____	\$50.00 Each	_____
Existing service release inspection only _____	\$40.00 /unit	_____
New Construction (1, 2 or 3 family) _____	\$90/Unit	_____
Existing 1, 2 or 3 family alterations or addition _____	\$40/unit PLUS items below	_____
Service Change # amps _____ # Services _____	\$.35/amp	_____
Electrical Units and Heat Zones _____	\$6.00 Each	_____
Electrical Strip Heaters # Elements _____	\$6.00 Each	_____
Generators _____ #kw _____	\$40.00 minimum or \$.30/kw	_____

COMMENTS: _____

PERMIT FEE _____ Minimum \$40 permit fee

1% State Surcharge _____

OTHER FEE _____ (i.e. re-inspection fee)

Total Permit Fee _____

WARNING: The approval of plans procured by misrepresentation of facts or conditions or improper action by any officer or employee of this department, does not legalize any illegal construction or agreement.

IN CONSIDERATION OF THE GRANTING OF THIS PERMIT, I or we, agree to save the City of Toledo harmless from any and all damages, I or we, do hereby covenant and agree to construct said work in all respects in compliance with the provisions of the Statutes of the State of Ohio and the Ordinances of the City of Toledo, and that all statements as made are correct and true and that all orders of Division of Building Inspection will be complied with. The undersigned further agrees to dispose of all construction waste material in accordance with applicable city laws.

Signature of Owner

Signature of Registered Contractor

(Do not write in these spaces)

Appeal Case No.
Date, 19
Approved
Disapproved
File Index Page No.

CITY OF TOLEDO
DIVISION OF INSPECTION
Application for
SWIMMING POOL PERMIT INGROUND

General Information

(All entries must be made by the applicant, and in ink or indelible pencil.)

Note: This application must be accompanied by duplicate set of plans, containing the following information—complete plot plan, drawing to scale, relation to existing structures; distance from property and set back lines; fence; elevations of pool and adjacent areas; pool dimensions, depths, piping layout with valve locations; location of filter and water heaters; method of waste disposal; location of dry well; fill line detail; and data on heater and gas piping including permit.

Number and Street Zip Code Located on the side
Between Street Street
Avenue and Avenue

Legal Description of Property

Owner Address

Builder Address License #: BTR

Architect or Designer Address
(Enter on line above architect's full name and Registration No.)

Type of Pool: Public Private Wading
Other (describe)

Dimensions: x x (length x width x depth)

Description: Rectangular Tee Ell Circular

Volume: cu. ft. gallons

Construction: walls floor
..... liner fence

Filter Type: Sand and Gravel Diatomaceous earth
Other (describe)

Circulating Pump: Make Model Capacity GPM

Recirculation: Once every hrs.

Other Equipment: Lighting Pool Heater Drain
or Valuation \$ Sq. Footage:

Date of Application, 19 Approved by

Health Dept. approval & an Electrical Permit are required. Permit Fee: (\$35.00 plus 5 cents/SF) \$

WARNING—The approval of plans procured by misrepresentation of facts or conditions, misstatements in application or through mistakes or improper action by any officer or employee of this department, does not legalize any illegal construction or arrangement.
IN CONSIDERATION OF THE GRANTING OF THIS PERMIT, I, or we, agree to save the City of Toledo, harmless from any and all damages. I, or we, do hereby covenant and agree to construct said work in all respects in compliance with the provisions of the Statutes of the State of Ohio and the Ordinances of the City of Toledo, and that all statements as made are correct and true, and that all orders of Division of Inspection will be complied with.

Name of Owner

Name of Firm
Signature of Firm taking out Permit for Owner or Lessee

Name of Lessee

By

By

Permit Tech _____

CITY OF TOLEDO

DEPARTMENT OF DEVELOPMENT

Permit #: _____

DIVISION OF BUILDING INSPECTION

REGISTRATION OF PORTABLE SWIMMING POOL ABOVE GROUND

=====

Owner _____ Address _____ Zip Code _____

Contractor _____ License Number _____

Pool Dimensions: Length _____ Width _____ Depth _____

Description: Regular _____ Circular _____ Tee _____ Ell _____

Manufacturer: _____

Circulating Pump: Make _____ Model _____ Capacity _____

Recirculation: Once Every _____ Hours

Other Filter Equipment (Skimmer, etc.) _____

=====

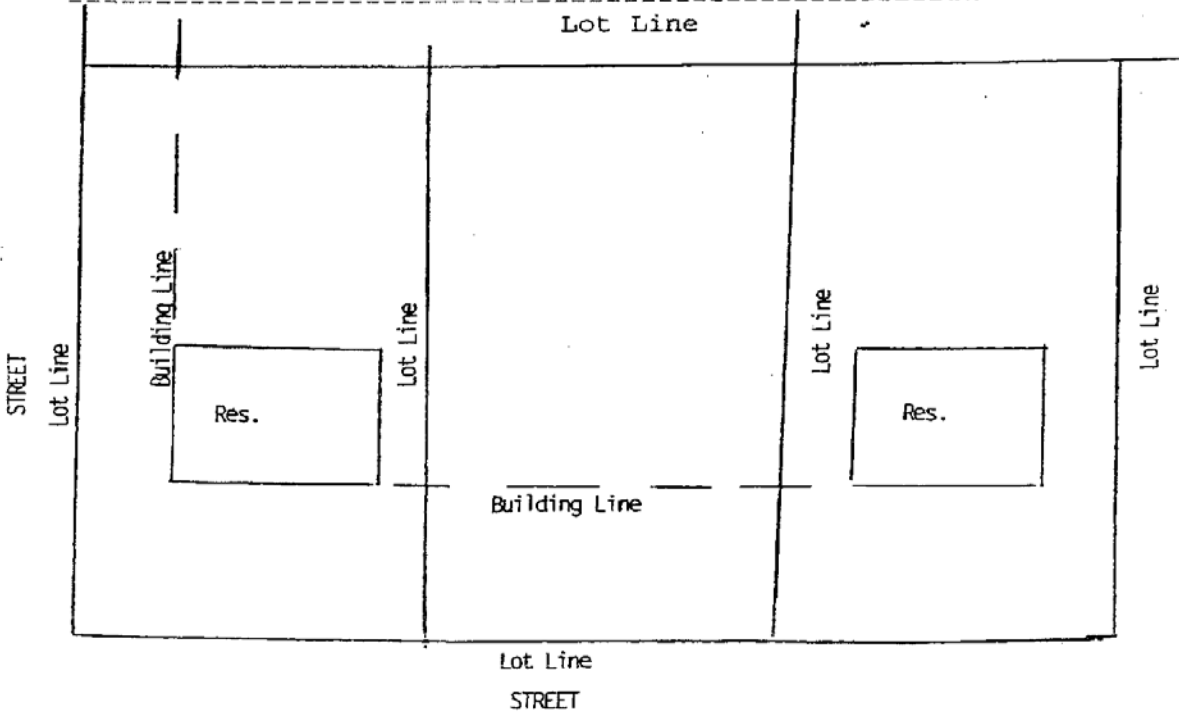

FEE \$20.00

The above plot plan is to be used to indicate pool location.

Contractor Signature _____ Date _____

Homeowner/Renter Signature _____ Date _____

Permit Tech _____